



Air Screwdriver Two Hammer Type

氣動螺絲起子: 雙鎚式



- High impact frequency.
- Low Counteraction

APPLICATION :

- Especially in heavy-productive industries (rattan, carpentry, electric, motor, aluminum, and hardware).

- 沖擊頻率高
- 反作用力小

用途 :

- 高量產工業尤佳(藤器、木器、馬達、鋁製品、五金工業等)



OP-301L90 F
Rear exhaust
後排氣

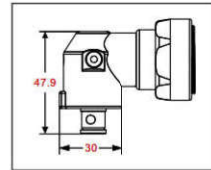

UNIT : (mm)



OP-311LHA F
Rear exhaust
後排氣

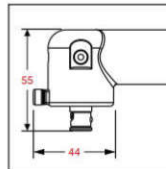

UNIT : (mm)



OP-310LHA F
Side exhaust
側排氣

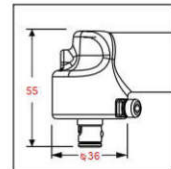

UNIT : (mm)

SPECIFICATION (air pressure at 90psi \ 6.2bar \ 6.3kg/cm²)

MODEL 型號	Screw Size Capacity 螺絲 攻拆尺寸	Working Torque 工作扭力		MAX. Torque 最大扭力		Free Speed 無負荷轉速	Air Consumption 耗氣量		Overall Length 全長		Air Inlet 入氣接頭	Net Weight 重量		Sound Level 噪音值
	mm	Nm	ft-lb	Nm	ft-lb	rpm	l/min	cfm	mm	inch	P.T	kg	lb	dB(A)
OP-301L90	4	15	11	40	30	9000	141	5	240	9.45	1/4	1.22	2.69	83
OP-311LHA	5~6	40	29	90	66	8500	240	8.5	265	10.43	1/4	1.56	3.44	90
OP-310LHA	5~6	40	29	130	96	7000	198	7	240	9.45	1/4	1.6	3.53	92



Air Screwdriver Two Hammer Type

氣動螺絲起子:雙槌式



OP-305 Q
360° Rotate side exhaust
360°調整側排氣



OP-320 Q
Push to start
Rear exhaust
觸壓啓動
後排氣



OP-808A1 OP-808 Q
Rear exhaust with muffler
後排氣低噪音



OP-301A1 OP-301 Q
Side exhaust
側排氣



OP-301AH OP-301H Q
Rear exhaust
後排氣



**OP-306 Q
OP-306F F**
Rear exhaust
後排氣



OP-809A1 Q
Rear exhaust with muffler
後排氣低噪音



**OP-310Q Q
OP-310F F**
2 Step pushstart trigger
Side exhaust
二段式扳機啓動
側排氣



**OP-328Q Q
OP-328F F**
360° Rotate side exhaust
360°調整側排氣



OP-100A1 Q
2 Step pushstart trigger
Rear exhaust
二段式扳機啓動
後排氣

SPECIFICATION(air pressure at 90psi、6.2bar、6.3kg/cm²)

MODEL 型號	Screw Size Capacity 螺絲 攻拆尺寸	Working Torque 工作扭力		MAX. Torque 最大扭力		Free Speed 無負荷轉速	Air Consumption 耗氣量		Overall Length 全長		Air Inlet 入氣接頭	Net Weight 重量		Sound Level 噪音值
	mm	Nm	ft-lb	Nm	ft-lb	rpm	l/min	cfm	mm	inch	P.T	kg	lb	dB(A)
OP-305	4	20	15	30	22	13500	141	5	170	6.69	1/4	0.57	1.26	89
OP-320	4~5	20	15	35	26	10000	127	4.5	195	7.68	1/4	0.67	1.48	80
OP-808	4~5	20	15	35	26	10000	127	4.5	190	7.48	1/4	0.76	1.68	71
OP-808A1	4~5	20	15	35	26	10000	127	4.5	200	7.87	1/4	0.76	1.68	71
OP-301	4~5	25	18	35	26	12000	127	4.5	178	7	1/4	0.7	1.54	89
OP-301A1	4~5	25	18	35	26	12000	127	4.5	185	7.28	1/4	0.7	1.54	89
OP-301H	4~5	25	18	40	30	10000	141	5	190	7.48	1/4	0.79	1.74	85
OP-301AH	4~5	25	18	40	30	10000	141	5	200	7.87	1/4	0.79	1.74	85
OP-306	6	45	33	200	148	8000	212	7.5	225	8.85	1/4	1.06	2.34	90
OP-306F	6	45	33	200	148	8000	212	7.5	225	8.85	1/4	1.06	2.34	90
OP-809A1	6	45	33	130	96	8000	184	6.5	230	9.06	1/4	1.2	2.65	79
OP-310Q	6~8	60	44	240	177	8000	254	9	200	7.87	1/4	1.06	2.38	97
OP-310F	6~8	60	44	240	177	8000	254	9	200	7.87	1/4	1.06	2.38	97
OP-328Q	6~8	65	48	240	177	8800	268	9.5	200	7.87	1/4	1.05	2.31	98
OP-328F	6~8	65	48	240	177	8800	268	9.5	200	7.87	1/4	1.05	2.31	98
OP-100A1	8	75	55	280	207	5500	240	8.5	265	10.43	1/4	1.7	3.75	85



Air Screwdriver Two Hammer Type

氣動螺絲起子：雙鎚式

F Type: 

Q Type: 



OP-403LN Q
Handle exhaust
下排氣



OP-301L Q
Handle exhaust
下排氣



OP-301LA1 Q
Handle exhaust
下排氣



OP-601A Q
Handle exhaust
下排氣



OP-306SL Q
OP-306SLF F
360° Rotate handle exhaust
360° 調整下排氣



OP-406LN Q
Handle exhaust
下排氣



OP-310LQ Q
OP-310LF F
Side exhaust
側排氣



OP-328LQ Q
OP-328LF F
360° Rotate handle exhaust
360° 調整下排氣



OP-100LA1 Q
Side exhaust
側排氣

SPECIFICATION (air pressure at 90psi \ 6.2bar \ 6.3kg/cm²)

MODEL 型號	Screw Size Capacity 螺絲 攻拆尺寸 mm	Working Torque 工作扭力		MAX. Torque 最大扭力		Free Speed 無負荷轉速 rpm	Air Consumption 耗氣量		Overall Length 全長		Air Inlet 入氣接頭 P.T	Net Weight 重量		Sound Level 噪音值 dB(A)
		Nm	ft-lb	Nm	ft-lb		l/min	cfm	mm	inch		kg	lb	
OP-403LN	4~5	25	18	35	26	11500	170	6	155	6.1	1/4	0.9	1.98	87
OP-301L	4~5	25	18	35	26	13000	198	7	143	5.63	1/4	0.9	1.98	88
OP-301LA1	4~5	25	18	35	26	13000	198	7	150	5.9	1/4	0.9	1.98	88
OP-601A	4~5	25	18	35	26	13000	170	6	155	6.1	1/4	0.86	1.9	82
OP-306SL	6	50	37	200	148	8000	226	8	184	7.24	1/4	1.2	2.65	87
OP-306SLF	6	50	37	200	148	8000	226	8	184	7.24	1/4	1.2	2.65	87
OP-406LN	6	50	37	150	111	8000	212	7.5	165	6.5	1/4	1.2	2.65	87
OP-310LQ	6~8	60	44	240	177	7700	240	8.5	195	7.68	1/4	1.38	3.04	93
OP-310LF	6~8	60	44	240	177	7700	240	8.5	195	7.68	1/4	1.38	3.04	93
OP-328LQ	6~8	60	44	240	177	8000	254	9	186	7.32	1/4	1.24	2.73	87
OP-328LF	6~8	60	44	240	177	8000	254	9	186	7.32	1/4	1.24	2.73	87
OP-100LA1	8	95	70	300	221	4800	240	8.5	185	7	1/4	2.24	4.94	92



Air Screwdriver Twin Ring Type

氣動螺絲起子: 雙環式



OP-308DA1 Q
OP-308DAF F
Rear exhaust
後排氣



OP-310DAQ Q
OP-310DA F
Side exhaust
側排氣



OP-330DQ Q
OP-330DF F
360° Rotate side exhaust
360°調整側排氣



OP-310LDAQ Q
OP-310LDA F
Side exhaust
側排氣



OP-409WA1 Q
OP-409WAF F
Handle exhaust
下排氣



OP-601DA Q
OP-601DAF F
Side exhaust
側排氣



OP-605DA Q
OP-605DAF F
Handle exhaust
下排氣



OP-906DAQ Q
OP-906DAF F
Handle exhaust
下排氣



OP-606DQ Q
OP-606DF F
Handle exhaust
下排氣

SPECIFICATION (air pressure at 90psi \ 6.2bar \ 6.3kg/cm²)

MODEL 型號	Screw Size Capacity 螺絲 攻拆尺寸	Working Torque 工作扭力		MAX. Torque 最大扭力		Free Speed 無負荷轉速	Air Consumption 耗氣量		Overall Length 全長		Air Inlet 入氣接頭	Net Weight 重量		Sound Level 噪音值
	mm	Nm	ft-lb	Nm	ft-lb	rpm	l/min	cfm	mm	inch	P.T	kg	lb	dB(A)
OP-308DA1	8	60	44	230	170	8000	226	8	220	8.66	1/4	1.32	2.91	85
OP-308DAF	8	60	44	230	170	8000	226	8	220	8.66	1/4	1.32	2.91	85
OP-310DAQ	8	68	50	300	221	8000	254	9	200	7.87	1/4	1.2	2.65	96
OP-310DA	8	68	50	300	221	8000	254	9	200	7.87	1/4	1.2	2.65	96
OP-330DQ	8	75	55	300	221	8500	268	9.5	200	7.87	1/4	1.2	2.65	98
OP-330DF	8	75	55	300	221	8500	268	9.5	200	7.87	1/4	1.2	2.65	98
OP-310LDAQ	8	68	50	300	221	8000	198	7	185	7.28	1/4	1.52	3.35	96
OP-310LDA	8	68	50	300	221	8000	198	7	185	7.28	1/4	1.52	3.35	96
OP-409WA1	8	55	41	270	200	8500	254	9	155	6.1	1/4	1.3	2.87	88
OP-409WAF	8	55	41	270	200	8500	254	9	155	6.1	1/4	1.3	2.87	88
OP-601DA	8	60	44	270	200	8500	240	8.5	155	6.1	1/4	1.54	3.38	94
OP-601DAF	8	60	44	270	200	8500	240	8.5	155	6.1	1/4	1.54	3.38	94
OP-605DA	8	68	50	300	221	9500	240	8.5	155	6.1	1/4	1.42	3.13	82
OP-605DAF	8	68	50	300	221	9500	240	8.5	155	6.1	1/4	1.42	3.13	82
OP-906DAQ	8	95	70	400	295	10000	311	11	144	5.66	1/4	1.6	3.52	92
OP-906DAF	8	95	70	400	295	10000	311	11	144	5.66	1/4	1.6	3.52	92
OP-606DQ	8	95	70	400	295	9000	296	10.5	140	5.51	1/4	1.47	3.24	98
OP-606DF	8	95	70	400	295	9000	296	10.5	140	5.51	1/4	1.47	3.24	98



Air Screwdriver Clutch Type

氣動螺絲起子:離合式



- While reaching the fixed torque, clutch will run automatically and protect the workpiece from being damaged.
- With torque regulator

APPLICATION :

- Apply to release or fasten the high-precise screw, especially for outside box setting in industries such as toy, electric, carpentry, and plastic.

- 扭力到達，離合器自動空轉，保護工作件不受損
- 可調整扭力設計

用途：

- 高精度螺絲攻拆，量產工業(玩具、電器、木器、塑膠等外殼裝配)

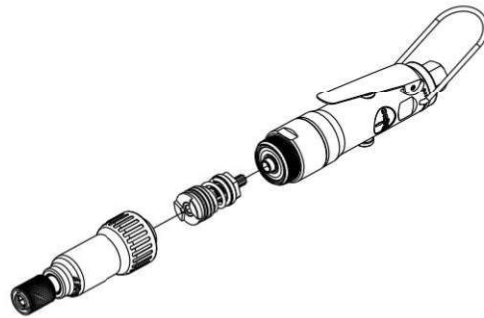

The method of adjusting torque:
Adjusting torque by using added wrench.
扭力調整方式：
使用附加扳手調整

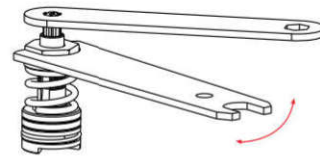

OP-302L90 F
360° Rotate side exhaust
360°調整側排氣

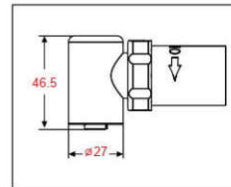

UNIT : (mm)

SPECIFICATION (air pressure at 90psi、6.2bar、6.3kg/cm²)

MODEL 型號	Screw Size 螺絲 攻拆尺寸	MAX. Torque 最大扭力		Free Speed 無負荷轉速	Air Consumption 耗氣量		Overall Length 全長		Air Inlet 入氣接頭	Net Weight 重量		Sound Level 噪音值
	mm	Nm	ft-lb	rpm	l/min	cfm	mm	inch	P.T	kg	lb	dB(A)
OP-302L90	5	2.5	1.8	1900	127	4.5	235	9.25	1/4	0.76	1.68	86



Air Screwdriver Clutch Type

氣動螺絲起子: 離合式



OP-103 Q
Side exhaust
側排氣



OP-304A1 OP-304 Q
Rear exhaust
後排氣



OP-304B1 OP-304B Q
Push to start type
Rear exhaust
觸壓啟動型
後排氣



OP-314A1 OP-314 Q
Rear exhaust with muffler
後排氣低噪音



OP-302 Q
360° Rotate side exhaust
360°調整側排氣



OP-103G Q
Side exhaust
側排氣

SPECIFICATION (air pressure at 90psi \ 6.2bar \ 6.3kg/cm²)

MODEL 型號	Screw Size Capacity 螺絲 攻拆尺寸	MAX. Torque 最大扭矩		Free Speed 無負荷轉速	Air Consumption 耗氣量		Overall Length 全長		Air Inlet 入氣接頭	Net Weight 重量		Sound Level 噪音值
		Nm	ft-lb		l/min	cfm	mm	inch		P.T	kg	
OP-103	4	2	1.4	2200	170	6	235	9.25	1/4	0.8	1.76	91
OP-304A1	4	2	1.4	1700	141	5	235	9.25	1/4	0.61	1.34	80
OP-304	4	2	1.4	1700	141	5	235	9.25	1/4	0.61	1.34	80
OP-304B1	4	1.5	1.1	1000	141	5	230	9.1	1/4	0.58	1.28	77
OP-304B	4	1.5	1.1	1000	141	5	235	9.25	1/4	0.6	1.32	77
OP-314A1	4	2	1.4	1700	127	4.5	240	9.45	1/4	0.7	1.54	70
OP-314	4	2	1.4	1700	127	4.5	240	9.45	1/4	0.7	1.54	70
OP-302	5	2.5	1.8	2400	141	5	220	8.66	1/4	0.63	1.39	89
OP-103G	6	8	5.9	600	170	6	265	10.43	1/4	0.95	2.1	90



Air Screwdriver Clutch Type

氣動螺絲起子:離合式



OP-301LC Q

Handle exhaust
下排氣



OP-404LN Q

Handle exhaust
下排氣



OP-405LN Q

Handle exhaust
下排氣



OP-301LCG Q

Handle exhaust
下排氣



Air Screwdriver Clutch Type

氣動螺絲起子:離合式

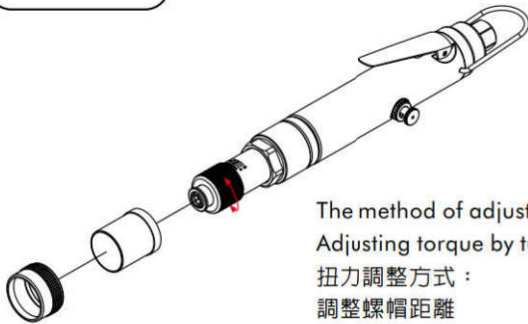
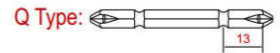

The method of adjusting torque:
Adjusting torque by turning the nut.
扭力調整方式:
調整螺帽距離



OP-5C1218 F

Rear exhaust
後排氣



OP-5C1419 F

Rear exhaust
後排氣



OP-5C1515 F

Rear exhaust
後排氣



OP-5C5415 F

Handle exhaust
下排氣

SPECIFICATION (air pressure at 90psi、6.2bar、6.3kg/cm²)

MODEL 型號	Screw Size 螺絲 攻拆尺寸 mm	MAX. Torque 最大扭力		Free Speed 無負荷轉速 rpm	Air Consumption 耗氣量		Overall Length 全長		Air Inlet 入氣接頭 P.T	Net Weight 重量		Sound Level 噪音值 dB(A)
		Nm	ft-lb		l/min	cfm	mm	inch		kg	lb	
OP-301LC	4	2	1.4	2500	212	7.5	200	7.87	1/4	1.04	2.29	88
OP-404LN	4	2	1.4	2200	184	6.5	200	7.87	1/4	1	2.2	90
OP-405LN	5	7	5.1	550	184	6.5	225	8.86	1/4	1.2	2.65	87
OP-301LCG	6	8	6	600	212	7.5	230	9.06	1/4	1.15	2.54	88
OP-5C1218	4	2.5	1.8	1800	127	4.5	228	8.98	1/4	0.76	1.68	80
OP-5C1419	5	3	2.2	1900	127	4.5	229	9.01	1/4	1.01	2.23	85
OP-5C1515	5	4	2.9	1450	170	6	279	10.98	1/4	0.97	2.14	80
OP-5C5415	5	4	2.9	1500	212	7.5	190	7.48	1/4	1	2.2	80



Air Screwdriver Clutch Type

氣動螺絲起子:離合式

The method of adjusting torque:
Adjusting torque by using PH1 screwdriver.
扭力調整方式:
使用PH1起子調整

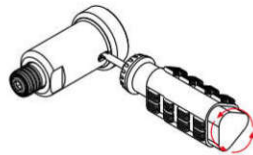

OP-2C8425 F
Composite handle
Handle exhaust
複合材料把手
下排氣



SPECIFICATION(air pressure at 90psi、6.2bar、6.3kg/cm²)

MODEL 型號	Screw Size Capacity 螺絲 攻拆尺寸	MAX. Torque 最大扭力		Free Speed 無負荷轉速	Air Consumption 耗氣量		Overall Length 全長		Air Inlet 入氣接頭	Net Weight 重量		Sound Level 噪音值
	mm	Nm	ft-lb	rpm	l/min	cfm	mm	inch	P.T	kg	lb	dB(A)
OP-2C8425	6	17	12.5	2500	283	10	212	8.34	1/4	1.08	2.38	88



Air Screwdriver Direct Driver Type

氣動螺絲起子:直接驅動式

For woodworking screws
適用於木工螺絲



OP-3G8425 F
Composite handle
Handle exhaust
複合材料把手
下排氣



OP-3G8410 F
Composite handle
Handle exhaust
複合材料把手
下排氣



SPECIFICATION(air pressure at 90psi、6.2bar、6.3kg/cm²)

MODEL 型號	Screw Size Capacity 螺絲 攻拆尺寸	Free Speed 無負荷轉速	Air Consumption 耗氣量		Overall Length 全長		Air Inlet 入氣接頭	Net Weight 重量		Sound Level 噪音值
	mm	rpm	l/min	cfm	mm	inch	P.T	kg	lb	dB(A)
OP-3G8425	4	2500	283	10	155	6.1	1/4	0.9	1.98	88
OP-3G8410	5	1000	283	10	172	6.77	1/4	1.04	2.29	88



Air Screwdriver Positive Clutch Type

氣動螺絲起子: 確動離合式



Air Screwdriver Clutch Type

氣動螺絲起子: 離合式



OP-800A F
Handle exhaust
下排氣

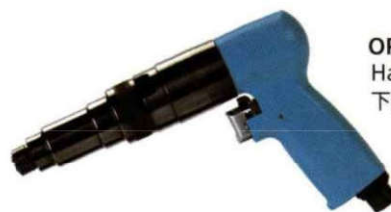

OP-800A06 F
Handle exhaust
下排氣

SPECIFICATION (air pressure at 90psi、6.2bar、6.3kg/cm²)

MODEL 型號	Screw Size 螺絲 攻拆尺寸	MAX. Torque 最大扭力		Free Speed 無負荷轉速	Air Consumption 耗氣量		Overall Length 全長		Air Inlet 入氣接頭	Net Weight 重量		Sound Level 噪音值
	mm	Nm	ft/lb	rpm	l/min	cfm	mm	inch	P.T	kg	lb	dB(A)
OP-800A	8	45	33.1	1800	367	13	175	6.89	1/4	1.13	2.49	88
OP-800A06	6	14	10.3	600	367	13	215	8.46	1/4	1.38	3.04	88