

SPK PRE-SET TORQUE WRENCHES

Audible and tangible "CLICK" when the set torque is reached, assuring a securely tightened joint. This series is well-suited for production line use.

FEATURES

- A single function wrench, used for a single setting combination of fastener size and torque setting.
- Most suited for tightening multiple same-size fasteners at the same torque in a production line.
- Setting confirmation unnecessary.
- Can be used effectively in confined spaces.
- Tightening to set torque only in the direction of the arrow indicator, but can be used for general tightening in the other direction as well.
- Accuracy : $\pm 3\%$ of pre-set value

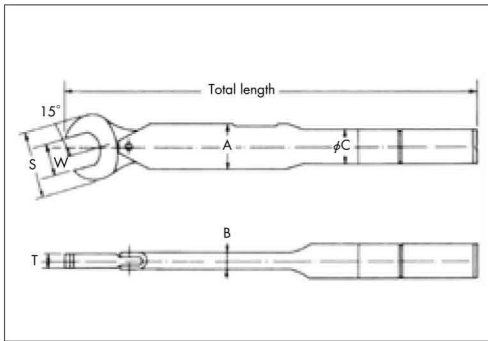

EXAMPLE OF ORDER

Model	Size(W)	Pre-set Value
N190SPK	10	× 14N·m

Model (kgf·cm)	Range (kgf·cm)	Old Model (N·m)	New Model (N·m)	Range (N·m)	Spanner sizes (W) (mm)				Total length (mm)	Dimensions (mm)					Weight (kg)															
										Head		Body																		
										S	T	A	B	C																
30SPK	5~30	N30SPK	N35SPK	0.5~3	5.5	6				152	24	5	19.5	7.5	15	0.1														
80SPK	15~80	N80SPK	N85SPK	1.5~8	5.5	6	7			175	24	5	19.5	7.5	15	0.11														
					8	9	10	11	12								13													
					10	11																								
190SPK	35~190	N190SPK	N195SPK	3.5~19	12	13	14			203	27	7	19.5	7.5	15	0.15														
					17	19					205						30													
											213						35													
380SPK	80~380	N380SPK	N385SPK	8~38	10	11	12	13	14	248	35	8	26.6	8.2	20	0.29														
					17	19					252						39													
					21	22	23	24			256						45													
					26	27	29	30	32		264						52	9												
670SPK	130~670	N670SPK	N675SPK	13~67	14	17	19	21		319	45	10	25.8	9.7	20	0.45														
					22	24	26				325	50				11	0.46													
					27	30	32				330	56						12	0.47											
					36	41					342	65								14	0.49									
					17	19	22				390	52										32.8	11.3	25	0.75					
24	26	27				397	57	12	0.77																					
29	30	32				403	62			12	0.79																			
36	41					404	64					14	0.81																	
19	22					435	53							12	0.94															
24	26					442	56									14	0.97													
27	30	32	36			449	64	14	0.99																					
41						457	73			15	1.1																			
19	22					585	72					15	35.6					12.5	27.2	1.1										
24	27													597	82					16	38.0	16	30	1.2						
30	32	36														650	67							16	38.0	16	30	1.4		
41								654	72																			16	38.0	16
22	24									662	82																			
27	30	32				833	74					18	43.3					17.8	34											
36	41													838	78					18	43.3	17.8	34							
24	27															843	82							18	43.3	17.8	34			
30	32							847	88																			18	43.3	17.8
36										860	94																			
41						860	94					18	43.3					17.8	34											
46														860	94					18	43.3	17.8	34							

* is the new model that is applied from 1st January, 2016.

RSPK PRE-SET, RING TORQUE WRENCHES

Can be used for accurate torque application even on joints inaccessible with other wrenches.

FEATURES

- The ring head of RSPK wrenches is offset at a 45° angle making certain joints particularly accessible.
- A single function wrench, used for a single setting combination of fastener size and torque setting.
- Most suited for tightening multiple same-size fasteners at the same torque on a production line.
- Setting confirmation unnecessary.
- Accuracy : ±3% of pre-set value

EXAMPLE OF ORDER

Model Size(W) Pre-set Value
 | | |
 N190RSPK 10 × 14N·m



★1 Model	★2 Ring head sizes (W) Head			Model	★3 Ring head sizes (W) Head			Model	Ring head sizes (W) Head				
	mm	S	T		mm	S	T		mm	S	T		
30RSPK N30RSPK	5.5	10	4	80RSPK N80RSPK	5.5	10	4	190RSPK N190RSPK	10	16	7		
	6		5		6		11		18	7			
	7	6	7		7	12	19		8				
	8				13	6	8		13	6	13	20	8.5
	9				14	6	9		14	6	14	22	9
10	16	7	10	16	7	17	26	10					
				11	18	7	19	29	10.5				
				12	19	8	22	33	12				

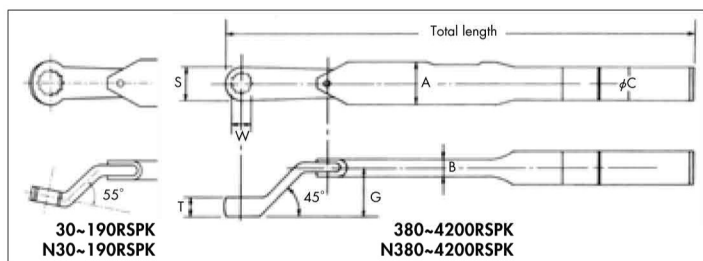

Model (kgf·cm)	Range kgf·cm	Old Model (N·m)	New Model (N·m)	Range N·m	Ring head sizes (W)				Total length mm	Dimensions (mm)					Weight kg						
					mm					S	T	Body									
					S	T	G	A				B	C								
30RSPK	5~35	N30RSPK	N3.5RSPK	0.5~3.5	5.5	6			175	★1		19.5	7.5	15	0.12						
					7	8	9	10													
80RSPK	20~90	N80RSPK	N9RSPK	2~9	5.5	6	7		197	★2		19.5	7.5	15	0.13						
					8	9	10														
					11	12															
190RSPK	40~210	N190RSPK	N21RSPK	4~21	10				222	★3		19.5	7.5	15	0.21						
					11	12	13	14	225						0.21						
					17	19	22		228						0.23						
					11	12	13	14	268						22	10	25	26.6	8.2	20	0.31
380RSPK	90~420	N380RSPK	N42RSPK	9~42	17	19	22		273	32	10	25	26.6	8.2	20	0.39					
					14	17			343	26						0.46					
					19	22	24		348	34						12	27	25.8	9.7	20	0.48
670RSPK	140~730	N670RSPK	N73RSPK	14~73	27	30	32		353	40	12	27	25.8	9.7	20	0.5					
					19				413	32						0.8					
					22	24			415	37						13	29	32.8	11.3	25	0.85
					27	30	32		428	44											0.9
1200RSPK	250~1,270	N1200RSPK	N127RSPK	25~127	36				437	50	15	31	32.8	11.3	25	1.0					
					19	22	24		470	37						1.2					
					27	30	32		474	44						16.5	33	35.6	12.5	27.2	1.3
					22	24	27		605	37											1.25
1600RSPK	320~1,700	N1600RSPK	N170RSPK	32~170	30	32			610	46	18	35	38	16	30	1.35					
					36				612	50						1.4					
					41				612	54						1.45					
					22				682	40						1.35					
					24	27	30		685	46						1.4					
2200RSPK	480~2,300	N2200RSPK	N230RSPK	48~230	32	36			688	52	18	37	43.3	17.8	34	1.45					
					41				688	56						1.5					
					27	30	32		880	52						1.55					
					36				885	55						1.6					
3100RSPK	680~3,200	N3100RSPK	N320RSPK	68~320	41				890	60	18	37	43.3	17.8	34	1.65					
					27	30	32		890	60						1.6					
					46				895	65						1.7					
					41				895	65						1.7					

* is the new model that is applied from 1st January, 2016.