



Series

for low pressure
for quick replacement for
Die and Mold

Features

- Space saving design for molds with closely spaced
- Long Sleeve socket facilitates connection/disconnection with plug embedded in mold.
- Various size and end configuration to suit a wide variety of mold application.

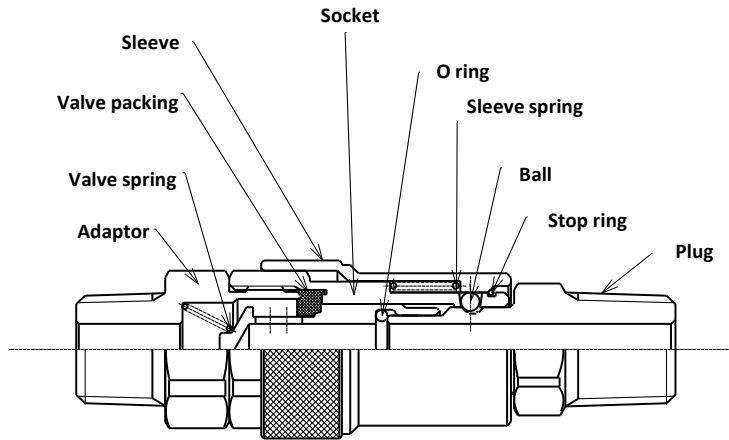

● Specification

Model	KC-01	KC-02	KC-03
Thread size	1/8	1/4	3/8
Material of socket/ plug body	Brass(C3604)		
Working pressure(MPa)	1.0		
Pressure resistance(MPa)	1.5		
Seal material	Viton(FMP)		
Working temperature range	-20°C ~ +180°C		
Applicable fluid	Water		

KC Series Socket

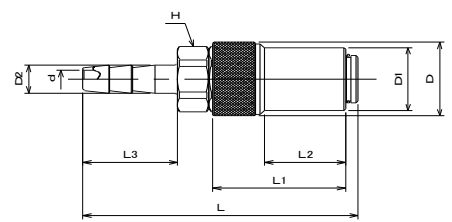
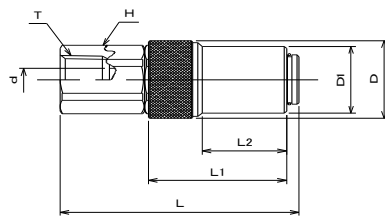
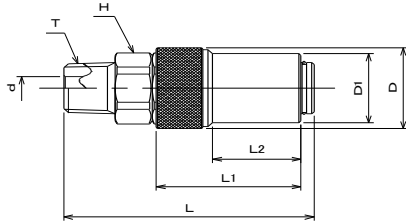

● Socket (model SM) (Male thread)

Model	Thread Size	Dimensions(mm)							Mass (g)	
		φD	φD1	φd	L	L1	L2	H HEX		T
KC-02SM	Rc1/4	21	18	6	51	29.5	18	17	R1/4	65
KC-03SM	Rc3/8	21	18	6	53	29.5	18	17	R3/8	75

● Socket (model SF) (Female thread)

Model	Thread Size	Dimensions(mm)							Mass (g)	
		φD	φD1	φd	L	L1	L2	H HEX		T
KC-02SF	R1/4	21	18	6	51	29.5	18	17	Rc1/4	70

● Socket (model SH) (Hose Nipple)

Model	Hose Size	Dimensions(mm)							Mass (g)		
		φD	φD1	φD2	φd	L	L1	L2		L3	H HEX
KC-02SH	1/4"	21	18	8	5	61	30	18	21	17	60
KC-03SH	3/8"	21	18	12	7	61	30	18	21	17	65

KC Series Plug

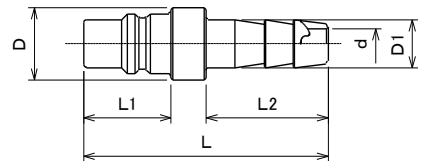
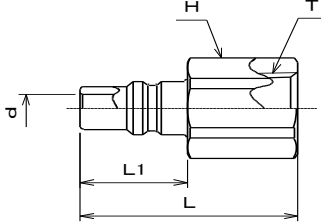
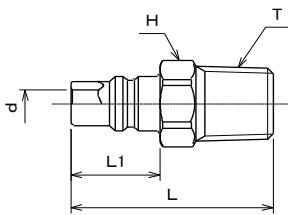

● Plug (model PM) (Male thread)

Model	Thread Size	Dimensions(mm)					Mass (g)
		φd	L	L1	H HEX	T	
KC-01PM	Rc1/8	5.5	31	15	12	R1/8	14
KC-02PM	Rc1/4	6	34	15	14	R1/4	20
KC-03PM	Rc3/8	6	35	15	17	R3/8	35

● Plug (model PF) (Female thread)

Model	Thread Size	Dimensions(mm)					Mass (g)
		φd	L	L1	H HEX	T	
KC-01PF	R1/8	6	28	15	14	Rc1/8	16
KC-02PF	R1/4	6	31	15	17	Rc1/4	20
KC-03PF	R3/8	6	32	15	21	Rc3/8	35

● Plug (model PH) (Hose Nipple)

Model	Hose Size	Dimensions(mm)					Mass (g)	
		φd	φD	φD1	L	L1		L2
KC-02PH	1/4"	5	12	8	42	15	21	15
KC-03PH	3/8"	6	15	12	42	15	21	19

*Specifications are subjects to change without notice.