

Compact & Slim 14.4V Cordless Shut-Off Right Angle Impact Wrench

For tight spot fastenings with high-power, high speed and virtually no torque reaction



Shut-Off Range
10-**53** N·m

Maximum Torque
80 N·m
(After 0.0 sec.)

Torque control for
tight spot applications

Compact and slim right angle tool with advanced ergonomics to help improve your work efficiency

EYFME1's compact and slim body can fit easily in tight areas and provide more reach.

EYFME1 has virtually no torque reaction, so the tool can be used with only one hand even when torque requirement is high.



360° Rotating Head
(90°step size)

*Please make sure the screw to fix angle head isn't loose before use.



EYFME1 can reduce burdensome hand tool applications.

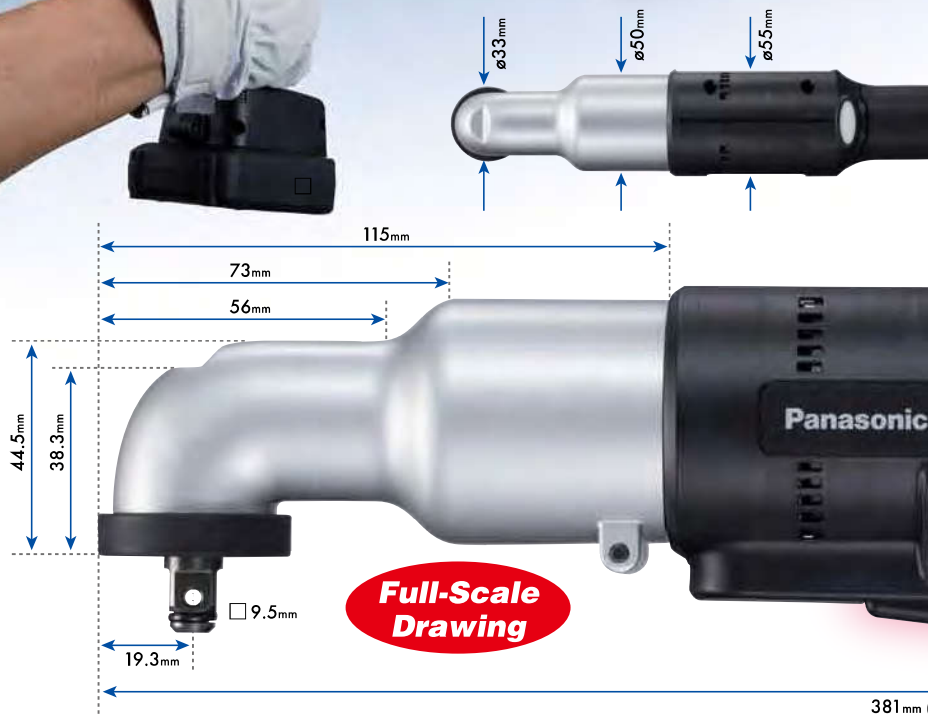

Full-Scale Drawing

Ergonomic design with user-friendly long paddle switch



14.4V Right Angle Impact Wrench with Torque Control



Advanced Fastening Features

Cross Thread Reduction

The tool first reverses 360 degree, aligning the threads, greatly reducing the possibility of cross threads.

Reverse Rotation!

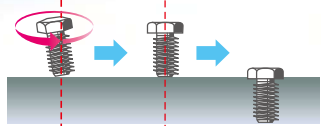

360° reverse rotation before fastening. The screws threads are aligned with the hole. Automatically shifting to normal rotation.



Rundown Error Detecting Function

If the clutch is activated before the programmable minimum runtime, the tool alerts the operator to a NOK fastening. (Time setting: 0.1-3.0sec, 0.1sec per stage)

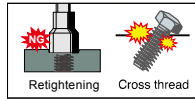

• Example with 3.0sec. normal time setting

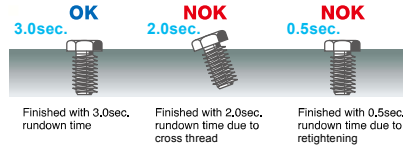

Maintenance Interval Alarm

When the total fastenings are within 10,000 fastenings of the preset maintenance interval, the display blinks notifying the operator. Once the tool reaches the preset interval, the tool is locked out from further use. This function can be set ON or OFF and is defined in 10,000 increment cycles. (Number of setting: 0-990,000pcs)

Additional Features

Paddle Switch

Long paddle switch provides options of grip position, center or back end.



Back end position provides more reach.

Center position provides better balance.

Tool Hanger

The tool can be hung on the balancer



Remote Control

Tool setting can be set only by remote control.



Tightening Confirmation Lamp
OK/NOK both visual and audible indicators. (Buzzer ON/OFF can be selected)



Brushless motor

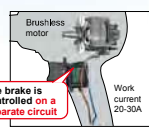

New hybrid switch



Floating Connector



LED Light



Cordless Right Angle Impact Wrench		
EYFME1C		
14.4V	Brushless Motor	
4.2Ah 2.0Ah	*Battery pack is not included	
Chuck size	<input type="checkbox"/> 9.5mm Square Drive Retainer ring and Pin-hole type	
Application	M6 bolt (Tensile bolt), M8 bolt (Normal-Tensile bolt), M10 bolt (Normal bolt)	
Maximum torque	approx. 80 N·m (M12, F mode, fastening 3sec.)	
Shut-off range	approx. 10-53 N·m	
Torque setting	30 stage + F (without torque setting mode)	
Flush detection mode setting	L1: For lighter loads during fastener run down L2: For prevailing torque during run down and varying joint rate applications	
No load speed (unit : rpm)	0 ~ 2300	
Impact per minute	0 ~ 3500	
Weight* (inc. battery)	approx. 1.5kg (EYFB41B), approx. 1.7kg (EYFB42B)	
Size	Length	381mm (EYFB41B), 399mm (EYFB42B)
	Height	approx. 96mm (Height of battery pack: approx. 101mm)
	Width	approx. 60mm (Width of battery pack: approx. 75mm)
Function	Torque adjustment	●
	Cross thread reduction	● (The tool rotates approx. 360 degree in reverse before fastening starts, Possible to choose ON/OFF)
	Rundown error detecting	● (Alert with Red light, Possible to set between 0 ~ 3 sec., 0.1 sec. per stage)
	Maintenance interval alarm function	● (Possible to set between 0 - 990,000 times, 10,000 times per stage)
	Retightening prevention function	● (Possible to set between 0 ~ 0.9sec., 0.1 sec. per stage)
	LED light	● (Possible to choose from the 2 LED light modes by ON/OFF switch or trigger switch interlocked)
	Buzzer	● (Possible to choose from the 3 buzzer modes, No buzzer, buzzer with OK or buzzer with NOK)
	Tightening confirmation lamp	● (OK fastening: Green lamp, NOK fastening: Red lamp)
	Battery indication lamp	● (3 stage)
	Auto battery shut down	●
Work capacity / Fastening speed	<M10: 53 N·m, Stage: 25> (EYFB41B) approx. 120 pcs/pack, approx. 2.2 sec/1pcs (EYFB42B) approx. 250 pcs/pack, approx. 2.2 sec/1pcs	
Charging time	(Battery Pack EYFB41, Charger EY0L82B) Usable Charge: approx. 35min., Full Charge: approx. 40min (Battery Pack EYFB42, Charger EY0L82B) Usable Charge: approx. 50min., Full Charge: approx. 60min	

Tightening Torque Chart (for Reference Use)

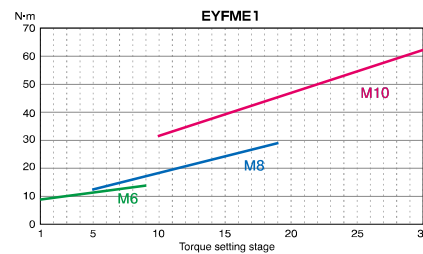

The values illustrated on this chart were measured under Panasonic measuring condition and are provided for reference purposes. Actual tightening torque varies with ambient conditions (the particular bolt being tightened, hardware being used, method of holding the bolt in place, etc.).

<Optional Accessory>

14.4V Li-Ion Battery Pack
EYFB42B, EYFB41B



Charger
EY0L82B



Remote Control
EYFA31B



Protector for Battery
EYFA04-H (gray)
EYFA06-H (gray)



Tool Hanger
EYFA41B



Protector for Tool
EYFA12
-A (blue), -Y (yellow)
-H (gray), -G (green)

